

AccuPower Lithium Golf Kit

AP-1415

Special design, compatible with a variety of electric golf trolleys
Lithium ion rechargeable battery 14.4V | 15.4Ah + intelligent charger unit with LCD display

AccuPower Lithium Golfkit Model: AP-1415

Special design, compatible with a variety of electric golf trolleys
Lithium ion rechargeable battery 14.4V | 15.4Ah + intelligent charger unit with LCD display



Technische Innovation
für den Golfsport







Higher energy: 14.4V / 15.4 Ah
Improved safety
Cells are always balanced
Long life
Lower weight: approx. 1.4 kg
Dimensions: L x W x H; 138 x 75 x 66mm



www.accupower.at

The combination of lithium technology and intelligent electronics makes it possible

Product Specifications

Charger (AP1222-1):

Input: AC 100-240V~ 1.8A 50-60Hz

Output: Adaptor: DC 16.8V 3A (MAX) 90W

USB: DC 5V 1A (MAX) 5W

Golf trolley battery pack (4S7P BCMICR18650F5):

Lithium ion battery pack 4S7P

Nominal voltage: 14.4V (max. 16.8V)

Capacity: 221.7Wh / 15.4Ah

Max. charging current: 5A

Max. discharge current: 15A

Operable temperature range: -100 to + 50 °C

Dimensions of the Battery-Pack: : L x W x H; 138 x 75 x 66mm

Weight: approx. 1.4 kg

Product components

1. Charger unit with LCD display
2. Mains cable for charger unit
3. Adaptor for golf trolley
4. Golf trolley battery pack (Lithium ion rechargeable battery pack with 4 cells 14.4V)

Charger unit with LCD

Instructions for Use

Rapid charger unit for lithium ion and lithium polymer rechargeable battery packs with 4 cells (14.4V)

Functions:

1. Charge directly from the golf trolley battery (lithium ion and lithium polymer rechargeable battery packs with 4 cells 14.4V), using the matching adaptor for the golf trolley (supplied with the AccuPower Golf Kit)
2. Power or charge a mobile phone, iPod™, MP3 player, digital camera, etc. from the **USB port**.
3. The battery charge level is shown by a graphic indicator on the LCD and a change in the backlight.
4. Can be used worldwide thanks to wide input voltage range (100-240V AC / 50-60 Hz.)
5. All functions of the device are microprocessor-controlled. The voltage is set automatically by the adaptor (included), the charging of the batteries is monitored and the charge level is displayed.
6. Impact-resistant casing
7. Safety features: overheating cutoff, overvoltage protection of output, overcurrent protection, short-circuit-proof construction and safety timer function.

How to use

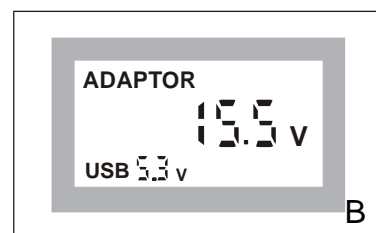
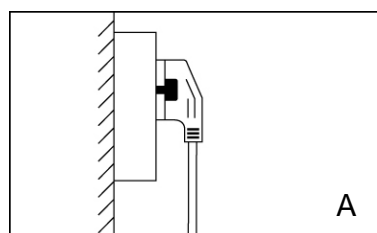
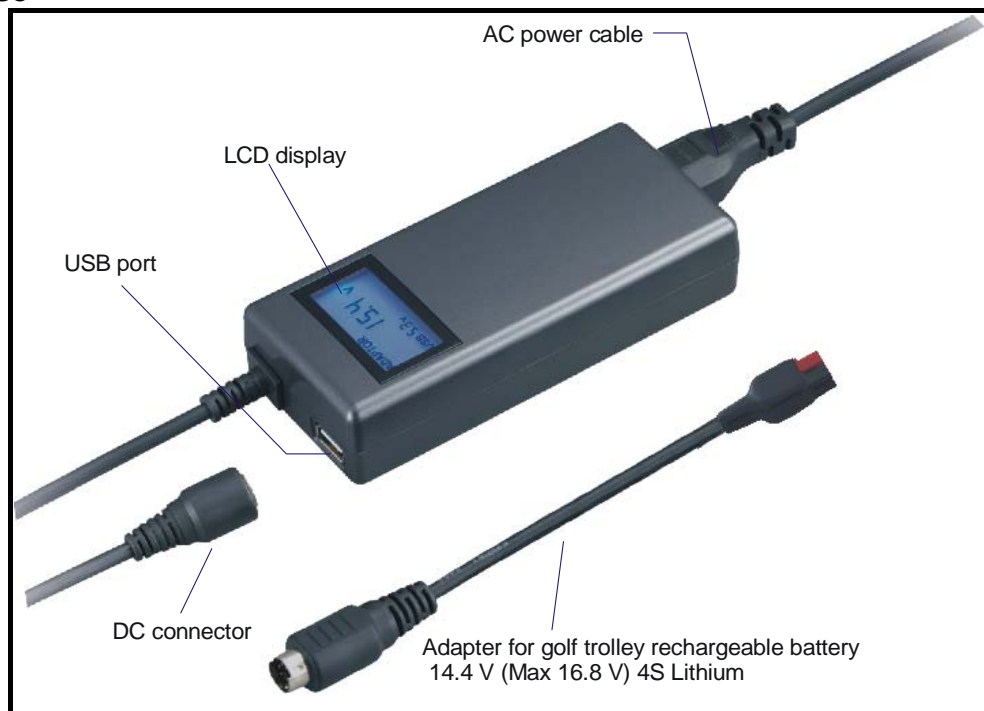

1. Plug the mains plug into a socket (Fig. A).

Fig. B shows the display when the adaptor for the golf trolley is not connected to the charger.

2. Connect the adaptor for the golf trolley to the charger (Fig. C). The charger automatically chooses the program for the golf trolley battery pack and the display changes to "CHARGER 16.8 V" (Fig. D)

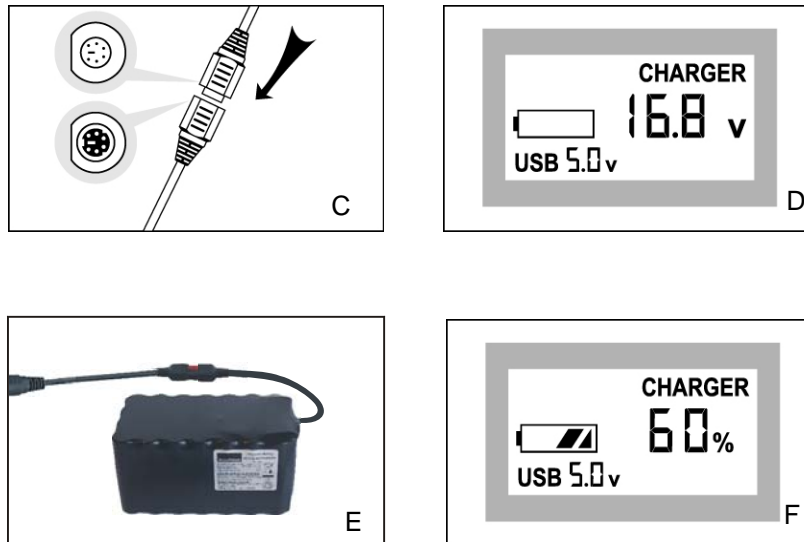

3. Connect the other end of the adaptor to the golf trolley battery pack (Fig. E). The display backlight switches to red and the charging process begins (Fig. F). The charge level of the battery is shown in steps of 5% on the LCD.

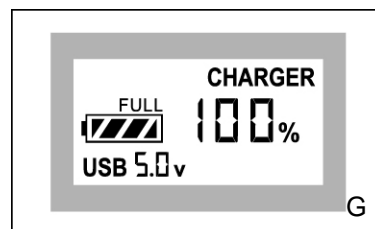

4. When charging is complete, the LCD backlight switches to blue and the word "FULL" appears next to the battery symbol (Fig. G).

How to use the USB charger

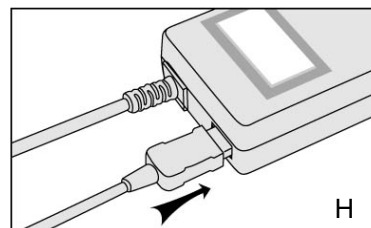

To use the USB charging function, simply plug the USB charging cable of your mobile phone, iPod™, MP3 player, digital camera, or other device into the USB port of the charger unit. Charging begins automatically (Fig. H).

Please note:

1. Do not expose the device to high temperatures or moisture!
2. The device warms up in use and may feel very warm to the touch.
3. Falls or heavy impacts can damage the electrical components inside the charger unit.
4. Never attempt to open or dismantle the charger unit. There is a danger of life-threatening electric shock due to the voltage on the components inside.
5. The manufacturer accepts no liability or responsibility for damages caused by incorrect operation, failure to follow the Instructions for Use, failure to comply with the maintenance instructions, incorrect maintenance or any other form of incorrect handling or misuse of the device, whether by the buyer or by third parties (e.g. incorrect operation, wrong connection, wilful damage, etc.)

Care and safety instructions for the Lithium Golf Kit battery

Never open or short circuit the battery. Never expose the battery to moisture or fire. Always make sure the battery is connected with the correct polarity (+/-). Always avoid short circuits which can be caused, for example, by metal objects. **CAUTION:** if the battery is **misused there is a danger of leaks, explosion or fire!** Only use chargers which are suitable for the specific type of battery. The useful lifetime of batteries is limited, and can be shortened by incorrect handling. To avoid damage to the battery, please observe the following instructions:

1. Always avoid¹⁾ deep discharging the battery
2. To store the battery for longer periods (**e.g. in winter**), **first make sure it is charged (at least 50%)**. Store the battery in a cool dry place.
3. Avoid exposing the battery to high ambient temperatures.
4. Always charge batteries only with a suitable charger.
5. Do not dispose of used batteries with domestic waste; always bring them to the designated collection centres. Think of the environment!

Treatment of deep-discharged batteries

If a battery becomes deep-discharged, it should be recharged without delay. The charger unit automatically detects if the battery is deep-discharged. After about 2 minutes, the charger will begin to blink. The charging process should then be restarted. These steps must be repeated until the battery reaches the critical threshold (you can recognize this by the fact that the charger no longer starts blinking 2 minutes after starting charging). Once the critical threshold has been crossed, charging continues normally.

If the battery is deep discharged, it will not be possible to complete charging within the safety timer limit (approx. 8h). If the battery charge level shows less than 70%, the battery should be charged a second time, so that it can be fully charged.

¹⁾ Deep discharge: this means that the battery is almost completely drained, to the point where it cannot supply any more power. The battery should be recharged immediately if this happens.